

Dobrinja

NOVOGRADNJA

STAN C302

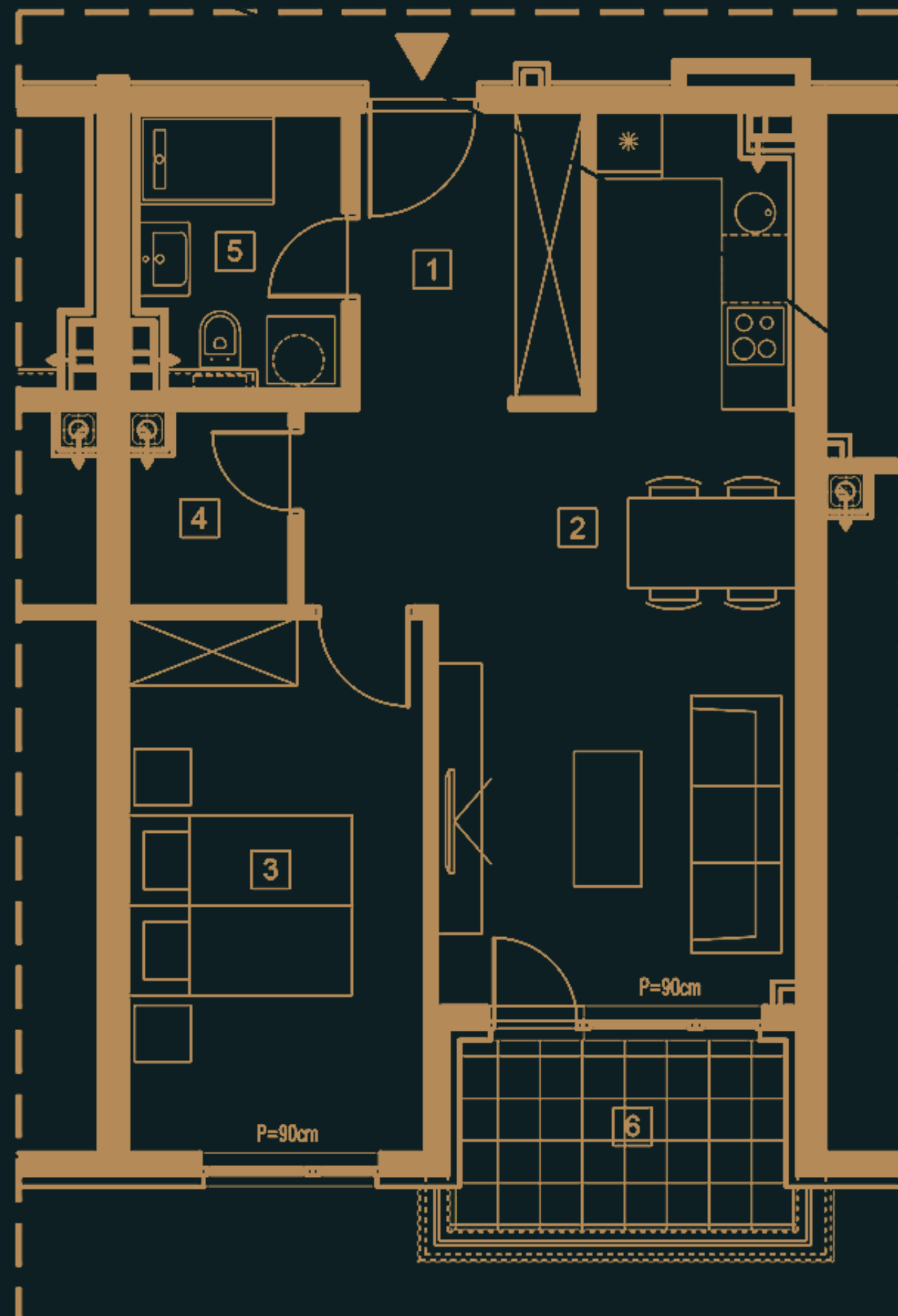

1	HOL	5.1m ²
2	DNEVNA SOBA, KUHINJA I TRPEZARIJA	23.0m ²
3	SOBA	12.4m ²
4	OSTAVA	2.3m ²
5	KUPATILO	4.3m ²
6	LOĐA (75%)	3.7m ²

UKUPNO

50.8m²

061 220 446

062 180 107